

# PLAN IT WHITEHORSE



## Report from the Porter Creek Bench Charrette

The Porter Creek Bench Charrette took place from November 5<sup>th</sup> to 9<sup>th</sup>. Sixty five residents, stakeholders, planners, architects, politicians, engineers and professionals participated in this collaborative planning workshop. By the end of the five day process, the charrette team had developed a concept plan for the neighbourhood as well as recommendations on how to make this plan a reality.

The charrette started on Sunday November 5<sup>th</sup>, with a public visioning workshop. Approximately seventy people listened to presentations, explored the definition of sustainability and identified community values. This became the starting point for the next day's design work.

On Monday, the participants were divided into seven teams, each with members from different backgrounds and skill sets. Over the next three days, each team worked on refining the vision and developing a land use concept for the area. Although the seven concepts had different elements, there were many similarities. By the end of the day Wednesday, it was possible to merge the best ideas from each group into one concept plan. This plan, with the proposed name Whistle Bend, is shown below.

On the final day of the charrette, new teams were created to focus on specific themes including phasing, implementation, transportation, municipal servicing,

housing and green space.

The charrette was an open planning process with many opportunities for the public to get involved. On Tuesday, Wednesday and Thursday evenings, the day's work was compiled and presented to the public at an open house. Each evening, approximately 35 people came to give their comments on the plans.

For the City, the charrette is an exciting new way to plan. By harnessing the talents and energy of all interested parties, a thoughtful and feasible plan was developed for this new neighbourhood. For more information, check our website at [www.whitehorse.ca](http://www.whitehorse.ca).

## Whistle Bend Concept

**The plan developed at the charrette includes:**

**Central Hub:** A mix of higher density residential units and commercial uses facing onto a central park and community gathering place.

**Green Space:** The protection of environmentally sensitive areas, a 3 m paved perimeter trail, designated motorized and non-motorized trails, a golf course buffers, a park overlooking McIntyre Creek and wide pedestrian greenways through each neighbourhood.

**Neighbourhoods:** Central higher density and mixed-use area framed by a curved boulevard. Each other neighbourhood would include a central node and a mix of housing types at a range of lower densities.

**Energy:** There was a focus on energy alternatives; ground source heating and storage, heat recapture and solar power were discussed. Increased standards for appliances and construction were also suggested.

**Proposed Name:** Whistle Bend, after the sharp turn on the Yukon River where boats would blow their whistles. The streets could be named after riverboats.

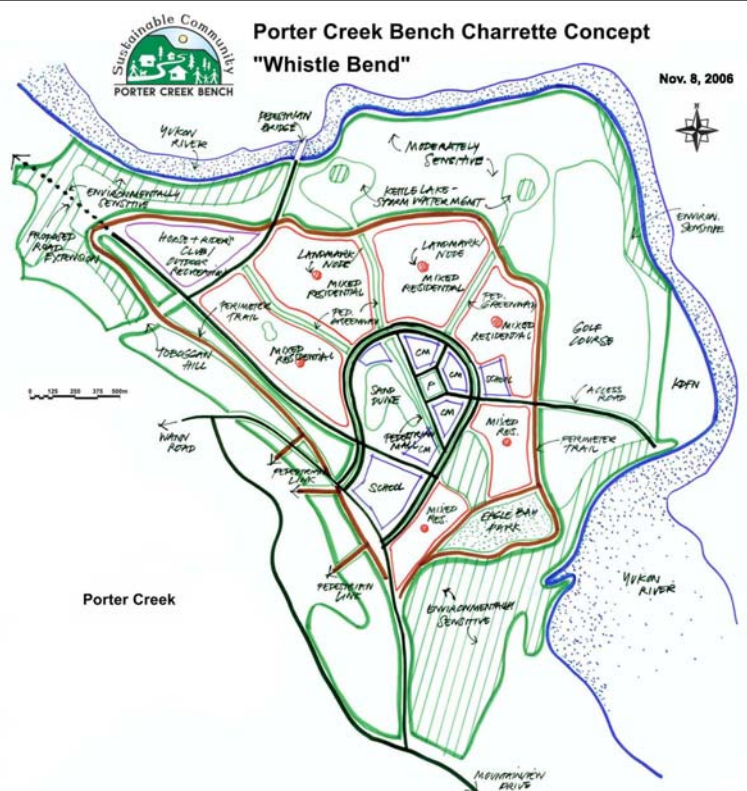

*Whistle Bend, a northern showcase for sustainable community design.*

# Talk of the Town

## Sustainability Plan

The City is beginning work on the Integrated Community Sustainability Plan (ICSP). As part of Canada's New Deal for Cities and Communities, Canada has transferred gas tax revenue to communities across Canada to complete plans which will identify, prioritize and build sustainable "green" municipal infrastructure. Municipal infrastructure in our communities requires replacement and new infrastructure must be built to last beyond the next 50 years.

The City will complete the ICSP in two phases. The first is the "Yukon Government Template" and the second phase is a more comprehensive, holistic plan.

The Agreement defines the ICSP as a

*"long term plan, developed in consultation with community members that provides direction for the community to realize sustainability objectives it has for the environmental, cultural, social and economic dimensions of its identity."* Once complete, the ICSP will allow the City to identify the infrastructure renewal projects that will be carried out here. Canada has allocated approximately 18 million dollars to Whitehorse for these projects.

## Coming & Going

Lesley Cabott, who has been the manager for the last 6 years, will be leaving our department for one year to take on a challenging new role as Project Manager for the Integrated Sustainability Plan. Mike Gau, the Senior Planner/Supervisor

has accepted the position as the Manager of Planning & Development Services for one year starting in January. Congratulations to both Lesley and Mike.

Doug Thorseth will be joining our department in February as the Supervisor of Building Inspections. Doug was previously employed by the City of Regina and has been involved in building inspection for 18 years. Welcome Doug!

Max Kerrigan has been working in our department as a Temporary Planner since November 2006. He is from Toronto and is currently working on a Masters in Landscape Architecture. Max will be working on follow-up to the Porter Creek Charrette.

# Takhini North Update

For several years Takhini North has been in need of infrastructure upgrades. Water lines do not meet the building code, sidewalks are crumbling, and in some cases roadways overlap private property. The City of Whitehorse is presently planning on having these problems fixed by 2008.

New residential lots will be developed as part of this project. Upgraded community amenities and infrastructure will benefit both new and existing residents.

Following the success of the Porter Creek Bench Charrette, a Takhini North Design Charrette will be held in late January or early February. This will provide an opportunity for the public to have a direct say in how the neighbour-

hood is planned.

In December, a Values Inventory session was held. Thirty five community members gave feedback on where development should or should not be considered in the Takhini North area. Antonio Zedda also presented some ideas for sustainable alternatives that could be considered in Takhini North such as district heating, geothermal, solar hot water, rainwater collection and on-site storm and wastewater runoff.

For more information send an email to [takhininorth@kza.yk.ca](mailto:takhininorth@kza.yk.ca), and ask to be put on the mailing list, or contact City planner Mike Ellis at 668-8347 or [mike.ellis@whitehorse.ca](mailto:mike.ellis@whitehorse.ca).

## Planning & Development Services

Planning: 867-668-8335  
Building Inspections: 867-668-8340  
Fax: 867-668-8395  
[www.planning.whitehorse.ca](http://www.planning.whitehorse.ca)

**Mike Gau** Manager 668-8333  
[mike.gau@whitehorse.ca](mailto:mike.gau@whitehorse.ca)

**Christine O'Connor**  
Senior Customer Service Rep. 668-8335  
[christine.oconnor@whitehorse.ca](mailto:christine.oconnor@whitehorse.ca)

**Dave Brink** Building/Plumbing Official 668-8340  
[david.brink@whitehorse.ca](mailto:david.brink@whitehorse.ca)

**Dawn Stagg** Customer Service Representative 668-8340  
[dawn.stagg@whitehorse.ca](mailto:dawn.stagg@whitehorse.ca)

**Doug Thorseth** Supervisor Building Inspections  
Starting February 1st, 2007

**Joy Janssens** Customer Service Representative 668-8340  
[joy.janssens@whitehorse.ca](mailto:joy.janssens@whitehorse.ca)

**Kinden Kosick** Development Officer 668-8334  
[kinden.kosick@whitehorse.ca](mailto:kinden.kosick@whitehorse.ca)

**Max Kerrigan** Planner 668-8343  
[max.kerrigan@whitehorse.ca](mailto:max.kerrigan@whitehorse.ca)

**Mike Ellis** Planner 668-8347  
[mike.ellis@whitehorse.ca](mailto:mike.ellis@whitehorse.ca)

**Nick Marnik** Building/Plumbing Official 668-8340  
[nick.marnik@whitehorse.ca](mailto:nick.marnik@whitehorse.ca)

**Pat Ross** Subdivision and Lands Coordinator 668-8339  
[pat.ross@whitehorse.ca](mailto:pat.ross@whitehorse.ca)

**Pete Craft** Building/Plumbing Official 668-8340  
[pete.craft@whitehorse.ca](mailto:pete.craft@whitehorse.ca)

**Zoë Morrison** Planner 668-8338  
[zoe.morrison@whitehorse.ca](mailto:zoe.morrison@whitehorse.ca)

**Vacant** Senior Planner/Supervisor

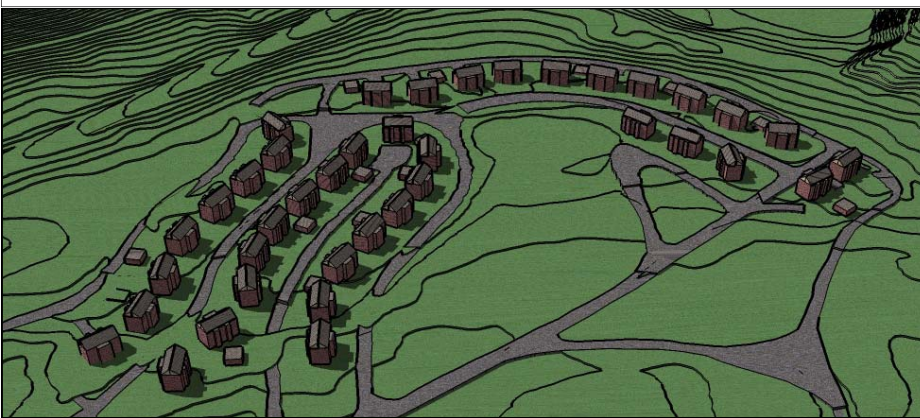

Three Dimensional Image of Takhini North

